

BINOXXO

- REGELN:
1. Es dürfen höchstens 2 X oder O nebeneinander sein.
 2. In einer Reihe müssen immer gleich viele X und O sein.

O	X	O	X	O	X
X	O	X	X	O	O
X	X	O	O	X	O
O	X	O	X	O	X
O	O	X	O	X	X
X	O	X	O	X	O

O	X	O	X	O	X
X	O	X	X	O	O
X	X	O	O	X	O
O	X	O	X	X	X
O	O	X	O	X	X
X	O	X	O	X	O

O	X	O	X	O	X
X	O	X	X	O	O
X	X	O	X	X	O
O	X	X	O	X	X
O	O	O	O	O	O
O	X	O	O	O	O

BINOXXO

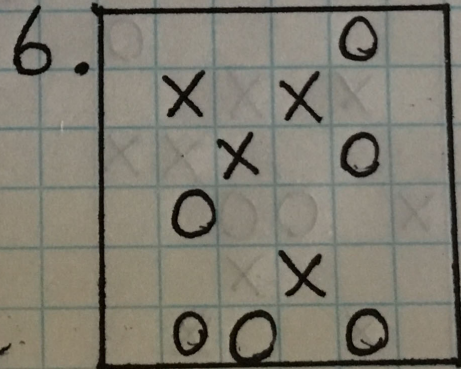
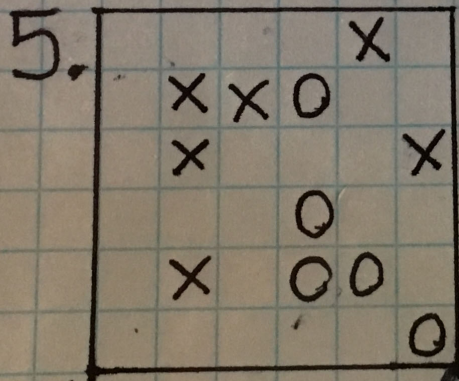
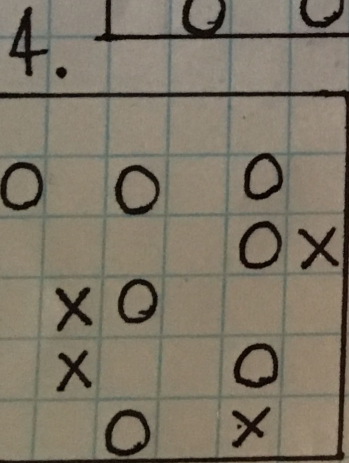
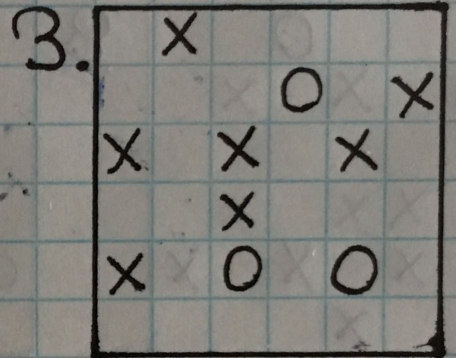
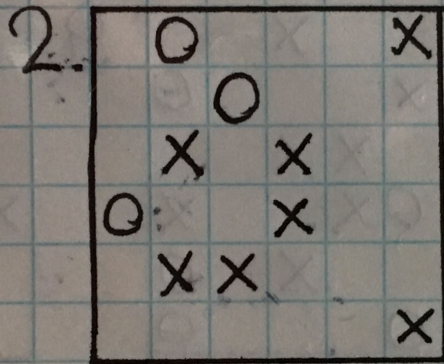
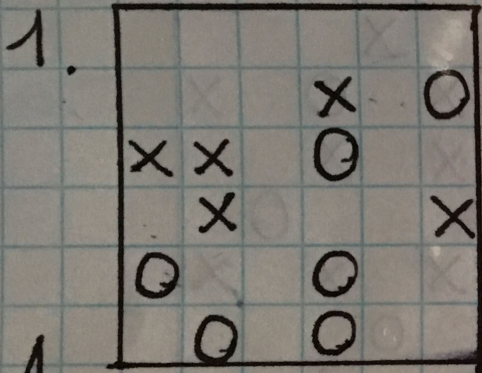

6.

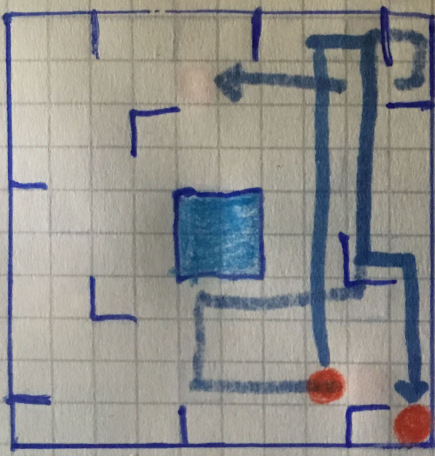

7.

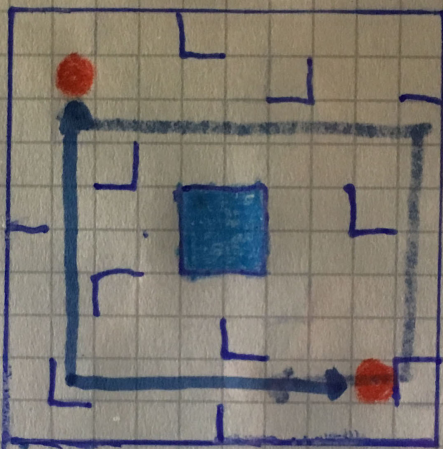

8.

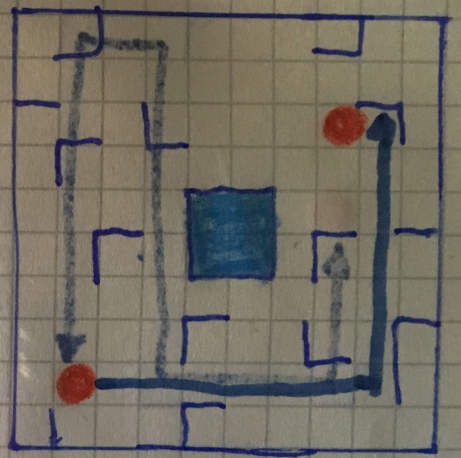

9.

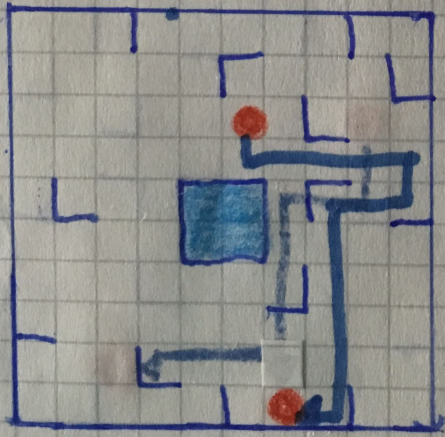

10.

